

**NOTES**

- 1 THIS DRAWING IS THE COPYRIGHT OF THE ARCHITECT AND MAY NOT BE REPRODUCED WITHOUT LICENCE.
- 2 DO NOT SCALE OFF THIS DRAWING.
- 3 ALL DIMENSIONS AND LEVELS ARE TO BE CHECKED ON SITE BY THE CONTRACTOR BEFORE COMMENCEMENT OF WORK AND ANY DISCREPANCIES REPORTED TO THE ARCHITECT.
- 4 NO RESPONSIBILITY CAN BE ACCEPTED FOR ERRORS ARISING ON SITE DUE TO UNAUTHORISED VARIATIONS FROM THE ARCHITECTS DRAWINGS.
- 5 DRAWINGS ISSUED ELECTRONICALLY MAY LOSE SOME DETAIL.

DESIGN RISKS FOR UNUSUAL OR COMPLEX HAZARDS

**AMENDMENTS**

Rev. No	Revision Description	Rev. Date	Issued by
A	Updated Wall, Door, Window Types + Roof Layout	16.07.14	JD
B	Glazing Package Update	18.08.14	JD
C	Post V.E. Update	01.09.14	JD
D	Post VE Roof Plan Update	04.09.14	JD
E	Post VE Conference Room Update	09.09.14	JD
F	Updated to End Users Comments	10.09.14	JD
G	Updated Ground Floor Slab	19.09.14	JD
H	Updated Details - Post VE	24.09.14	JD

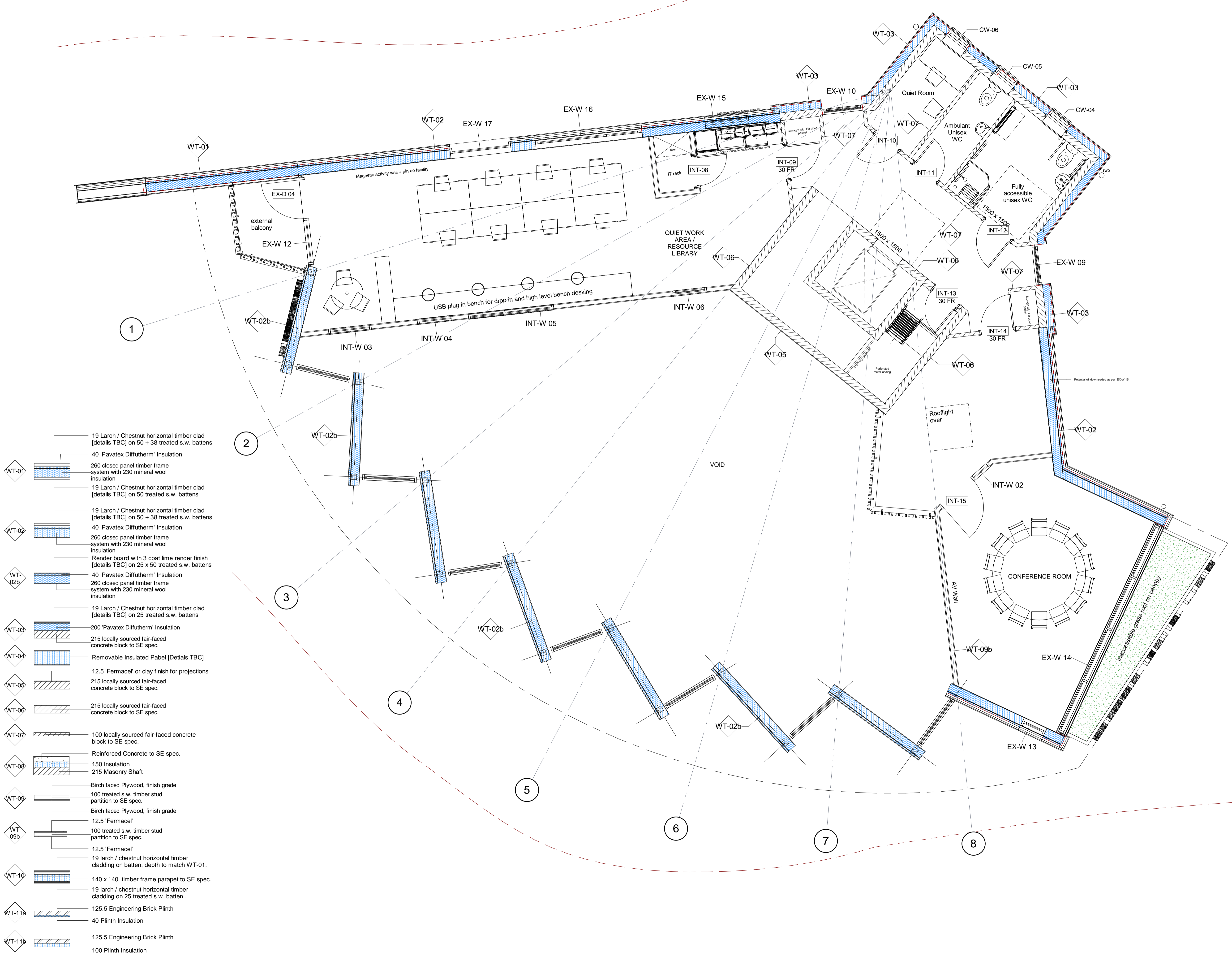

- WT-01 19 Larch / Chestnut horizontal timber clad [details TBC] on 50 + 38 treated s.w. battens  
40 'Pavatex Diffuftherm' Insulation  
260 closed panel timber frame system with 230 mineral wool insulation
- WT-02 19 Larch / Chestnut horizontal timber clad [details TBC] on 50 treated s.w. battens  
40 'Pavatex Diffuftherm' Insulation  
260 closed panel timber frame system with 230 mineral wool insulation
- WT-02b Render board with 3 coat lime render finish [details TBC] on 25 x 50 treated s.w. battens  
40 'Pavatex Diffuftherm' Insulation  
260 closed panel timber frame system with 230 mineral wool insulation
- WT-03 19 Larch / Chestnut horizontal timber clad [details TBC] on 25 treated s.w. battens  
200 'Pavatex Diffuftherm' Insulation  
215 locally sourced fair-faced concrete block to SE spec.
- WT-04 Removable Insulated Panel [Details TBC]
- WT-05 12.5 'Fermacel' or clay finish for projections  
215 locally sourced fair-faced concrete block to SE spec.
- WT-06 215 locally sourced fair-faced concrete block to SE spec.
- WT-07 100 locally sourced fair-faced concrete block to SE spec.
- WT-08 Reinforced Concrete to SE spec.  
150 Insulation  
215 Masonry Shaft
- WT-09 Birch faced Plywood, finish grade  
100 treated s.w. timber stud partition to SE spec.  
Birch faced Plywood, finish grade  
12.5 'Fermacel'
- WT-09b 100 treated s.w. timber stud partition to SE spec.  
12.5 'Fermacel'
- WT-10 19 larch / chestnut horizontal timber cladding on batten, depth to match WT-01.  
140 x 140 timber frame parapet to SE spec.  
19 larch / chestnut horizontal timber cladding on 25 treated s.w. batten .
- WT-11a 125.5 Engineering Brick Plinth  
40 Plinth Insulation
- WT-11b 125.5 Engineering Brick Plinth  
100 Plinth Insulation

**PROVISIONAL**

POYNTON BRADBURY WYNTER COLE  
Architects Ltd  
ATLANTIC STUDIO, TRELYON AVENUE  
ST. IVES, CORNWALL, TR26 2AD  
Tel. 01736 792000  
E-Mail: architects@pbwc.co.uk  
www.pbwc.co.uk

Job  
**3244 - Green Build Hub**  
Eden Project

Title  
**First Floor Plan**

Project/Sheet Status Revision  
**3244\ (--)\ 1001\ PR H**

Scale Date  
**1 : 50@A1 24/09/14**

Director In Charge Project Architect  
**RG JD**