

# Green Build Event

## Green Build Cornwall 2012 – 17/18 May 2012

The second annual Green Build Cornwall will be held at the Eden Project on 17/18 May 2012. This will be a chance to see what is happening in Cornwall in sustainable construction – from renewable

energy suppliers and options to the latest in building techniques and materials.

It will also be a chance to see the progress of the Green Build Hub. There will be an opportunity to tour the site, to meet the collaborators' and find out about their products.

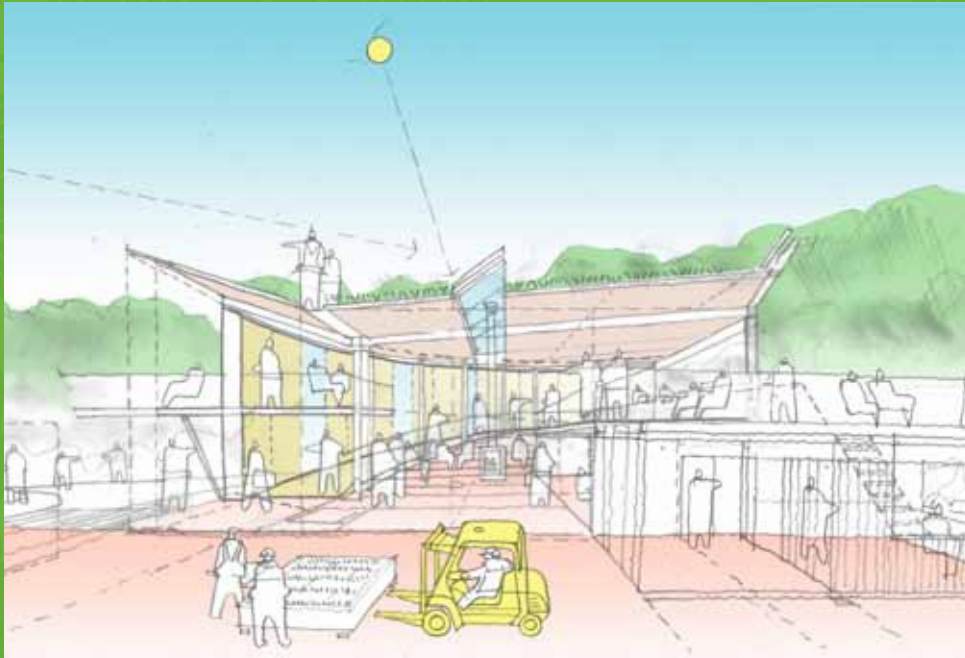

## Breaking new ground for Sustainable Construction in Cornwall



**A:** Cornwall Sustainable Building Trust,  
Tehidy Cottages, Burngullow Lane,  
St Austell, PL26 7TQ  
**T:** 01726 64651 **F:** 01726 219000

**E:** [claire@csbt.org.uk](mailto:claire@csbt.org.uk) / [paul@csbt.org.uk](mailto:paul@csbt.org.uk)  
**W:** [www.csbt.org.uk](http://www.csbt.org.uk)  
[facebook.com/CSBT2020](https://www.facebook.com/CSBT2020)  
[twitter.com/CSBT2020](https://twitter.com/CSBT2020)

*"We agree to work with CSBT to make all Cornwall's building as sustainable as it can be. We will seek the best environmental option in all our decisions and we will share best practice and learning so that our environment is always the winner"*

# About CSBT

---

## Our Vision:

Is of a Cornwall where hard to heat and treat homes are in the past and where all Cornwall's buildings are healthy sustainable and environmentally enhancing.

## Our Mission:

CSBT exists to influence and support decision making and to raise awareness of all aspects of sustainable building in Cornwall and the Isles of Scilly; to guide procurement and to deliver the Trust's

vision and so minimize the impacts of construction on the environment.

Cornwall Sustainable Building Trust has established itself in the last decade as the catalyst in Cornwall for progressing sustainable construction. With over 1000 associates and a history of major influence on companies and organisations locally, regionally and nationally; its aim is to work with all parties towards the common aim of Sustainability.

Since 2002 CSBT has been preparing the ground for this development.

# Green Build Hub

---

Run by the Cornwall Sustainable Building Trust, The Green Build Hub will be located at The Eden Project bringing together green build specialists from the charity as well as specialists from commercial and academic spheres.

The space is being designed and built as a cutting edge sustainable building exercise and will demonstrate tangibly what can and is being done in Cornwall to improve the sustainability of construction in the region and beyond. It will be University monitored and used for training, awareness raising and sharing of best practice. All collaborators will be able to use the facility to engage with the public.

CSBT wants to work with all parties in Cornwall, who are in the business of providing sustainable and replicable solutions, to demonstrate how we can

effectively adapt our buildings and lifestyles to climatic changes and resource depletion.

Despite huge local expertise, there is nowhere in Cornwall where the Green Build suppliers can engage the public with this knowledge. There is still widespread ignorance of the urgent need to adapt both our existing and new buildings to reduce their effect on the climate and dwindling finite resources. It has been difficult to reach the general public and to get them to understand that we all have to change our wasteful lifestyles and that making these changes is a life enhancing process. The latest developments will provide a shop window where the public can easily relate green techniques to their own lives and houses. CSBT will have a learning base that partners and public can share and utilise.

---

# The Construction

---

The Project Management of the build will be overseen by Sustain Cornwall Limited (SCL), The Eden Project and The Ocean Group. Using various collaborators we will bring together some exciting new sustainable products and building techniques, which will be constantly monitored for performance, and updated. The construction phase will be an ongoing training and education exercise – using local craftsmen in the build, whilst training and informing them of the new techniques and products available in the industry.

## Site Visits

The Collaborators will meet regularly on site to discuss the build, the training phases and the progress of the Hub.

Once the Hub is functional, collaborators will be encouraged to maintain and update their products and services and engage with the public on the use of techniques and products in their own projects.